



# RHEEM 5 STAR GAS STORAGE WATER HEATER



		2 - 5	275 or 305L	7 YEAR
GAS	5 STAR	PEOPLE	1st HOUR CAPACITY	CYLINDER WARRANTY <sup>1</sup>

## FEATURES

- **5 Star energy efficiency** – uses less gas than 3 or 4 Star water heaters, so saves on home gas bills
- **Mains pressure** at multiple taps – to service multiple hot water demands at once
- **145 L/hr recovery<sup>2</sup>** – so you're back in hot water fast
- **275L or 305L first hour capacity<sup>2</sup>** of hot water
- **Compact size** – 490mm diameter, for easy replacement of existing 3 star gas water heaters
- 7 Year Cylinder Warranty<sup>1</sup>

RheemPlus® 265/295 models available

- 50°C temperature limited models supply hot water at a maximum 50°C at all outlets in accordance with AS3498.
- No addition tempering valve required<sup>3</sup>

## WHY CHOOSE RHEEM GAS STORAGE HOT WATER?

- Designed for Australia's tough conditions, utilising over 70 years of experience
- Capacities to suit most family sizes and hot water requirements
- Fast hot water recovery
- Mains pressure water delivery for steady, hot and strong hot water
- Full technical support through Rheem's National Service Network
- Available in Natural Gas



COMES ON STEADY, HOT AND STRONG

INSTALL A





# RHEEM 5 STAR GAS STORAGE WATER HEATER

## MAINS PRESSURE HOT WATER WHEN YOU NEED IT

Mains pressure gas storage water heaters are your guarantee of consistent hot water. You can be sure of a strong flow of hot water, even to multiple taps at once.

With a range of capacities, there is a model for every budget and family, and Rheem's modern design complements any home.

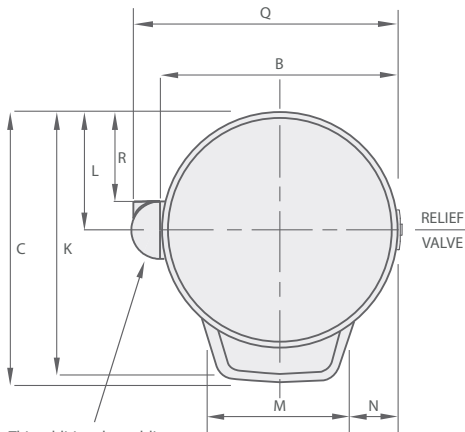

This additional moulding fitted to RheemPlus® only

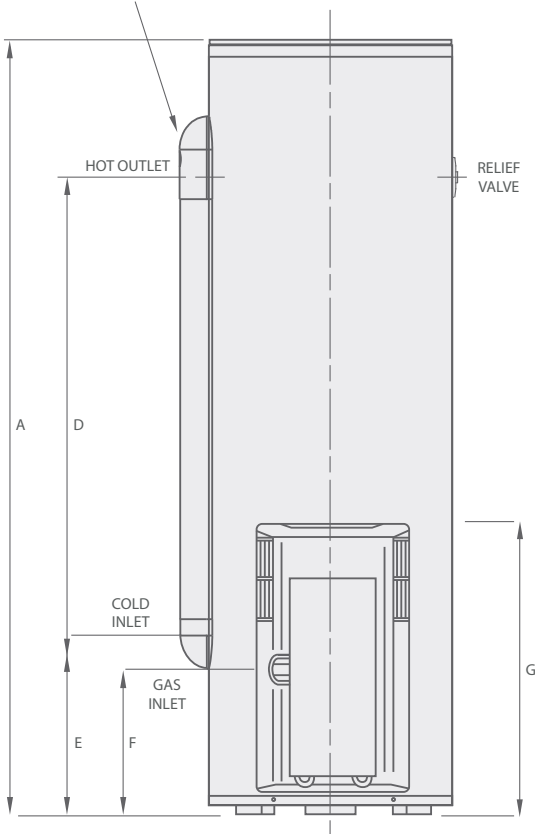

MODEL	RHEEM 5 STAR GAS	
	265	295
Rheem 5 Star	350265	350295
RheemPlus® 5 Star (50°C limited) <sup>3</sup>	354265	354295
<b>Suitable for no. of people</b>		
Moderate Climate	2-4	3-5
Cool Climate	2-3	3-4
Cylinder Warranty <sup>1</sup>	Years	7
Gas Type	Natural Gas	
Gas Energy Rating	Stars	5.3
Storage Capacity	Litres	130
Recovery Rate @ 45°C	L/hr	145
First Hour Capacity <sup>2</sup>	Litres	275
Hourly Gas Consumption Natural Gas	MJ/h	30
<b>Dimensions</b>		
A	mm	1600
B	mm	490
C	mm	556
D	mm	988
E	mm	332
F	mm	302
G	mm	605
K	mm	528
L	mm	240
M	mm	300
N	mm	95
Q (RheemPlus® only)	mm	545
R (RheemPlus® only)	mm	182
Weight Empty	kg	75
Relief Valve Setting	kPa	1400
Expansion Control Valve (ECV) Setting	kPa	1200
<b>Max. Water Supply Pressure</b>		
with ECV	kPa	960
without ECV	kPa	1120
Water Connection	RP ¾/20	RP ¾/20
Gas Connection	RP ½/15	RP ½/15

<sup>1</sup> Warranty: 7 Years on Cylinder, 3 Years Labour on Cylinder, 1 Year Parts & Labour warranty on all other components for Domestic (non-Commercial) installations. 7 Year warranty applies to product manufactured after September 1, 2013. See Rheem's warranty set out in the product's Owner's Manual or view it at [www.rheem.com.au/warranty](http://www.rheem.com.au/warranty).

<sup>2</sup> Based on 45°C temperature rise.

<sup>3</sup> 50°C factory pre-set models supply hot water at a maximum 50°C at all outlets in accordance with AS 3498. Some applications may require tempering, refer to AS 3500.4.

© Registered Trademark of Rheem Australia Pty Ltd.

Materials and data are subject to change without notice.



Rheem Australia Pty Ltd.

1 Alan Street, Rydalmere, New South Wales 2116, Australia  
PO Box 7508, Silverwater, New South Wales 2128, Australia.

Rheem\_MKT\_5 Star Gas Storage Spec Sheet 09/2016

